

CERTIFICATE OF LOCATION OF GOVERNMENT CORNER

West 1/4 Corner of Section 35, Township 107N, Range 42W, 5th P.M.

STATE OF MINNESOTA, County of Murray

the corner location shown on the sketch

On 9/19/05 found nothing. Dug 10' X 20' X 4' hole with backhoe and found no evidence of corner.

left monument as found lowered monument, removed monument (explain)

On 9/27/05 placed a 1" Iron Pipe with survey cap 23008 midway and on line between the Northwest and Southwest corner of section as per PLS instructions. Corner is 3' East of Twp. Rd. C and 6' North of fences east and west.

SKETCH OF REFERENCE TIES

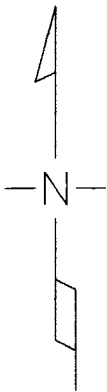

NW COR. SEC. 35

PROJECT COORDINATES

N = 168875.59
E = 474466.01

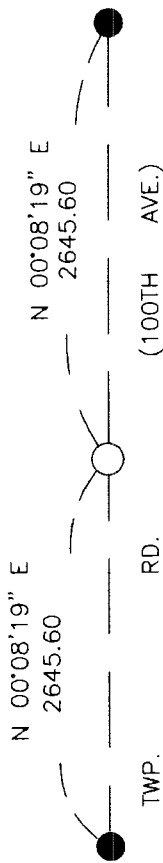

W 1/4 COR. SEC. 35

N = 166229.99
E = 474459.61

SW COR. SEC. 35

N = 163584.40
E = 474453.21

Statement of evidence relative to this corner location is on back of page.

I hereby certify that this document and the data contained herein was prepared by me or under my direct supervision.

Perry L. Zierke
SIGNATURE

9-27-05
DATE

OFFICE OF THE COUNTY RECORDER

I hereby certify that this document was filed in the Co. Recorder's Office at _____ on the

_____ day of _____

County Recorder _____

By _____, Deputy

DOCUMENT NO. _____

MN. REGISTRATION NO. 23008

Land Surveyor, Professional Engineer

County Surveyor, County Engineer